

DESIGN CONSULTANTS

#1281, Trichy Road, Coimbatore – 641 018, Tamil Nadu, India.

Voice: 98422 30124.

E-mail: agdc.archanand@gmail.com

ESTIMATE FOR INTERIOR FURNISHING

ABSTRACT AND DETAILED

ESTIMATE FOR

INTERIOR FURNISHING,

ELECTRICAL, DATA CABLING AND

AIRCONDITIONING WORKS

AT

M/s. BANK OF INDIA – KABISTHALAM BRANCH

MADURAI CIRCLE, TAMIL NADU.

ARCHITECTS

S. VIJAY ANAND., B.Arch., Mem COA., AIIA,

DESIGN CONSULTANTS

#1281, Trichy Road, Coimbatore – 641 018, Tamil Nadu, India.

Voice: 98422 30124.

**ARCHITECTURE PLANNING STRUCTURES
INTERIORS & LANDSCAPE**

**ESTIMATE FOR THE INTERIOR FURNISHING, ELECTRICAL,
DATA CABLING AND AIR CONDITIONING WORKS FOR
M/s.BANK OF INDIA, AT KABISTHALAM BRANCH, MADURAI, TAMILNADU.**

SUMMARY SHEET

<u>Sl. No</u>	<u>Type of Work</u>		<u>Amount Quoted</u> <u>(Rs.)</u>
1	Interior Furnishing Works - Banking hall	Rs.	1,017,000.00
2	Electrical Works - Banking hall	Rs.	514,000.00
3	Data Cabling Works- Banking hall	Rs.	51,000.00
4	Air Conditioning works - Banking Hall	Rs.	170,000.00
TOTAL		Rs.	1,752,000.00
SAY		Rs.	1,752,000.00

(In words: Rupees Seventeen Lakhs and Fifty Two Thousand Only)

Notes: All items are excluding of GST and other applicable taxes, unless specified

Date :

Signature of the **Zonal Manager**
Bank of India, Zonal Office – Madurai.

Date :

Signature of the Architect

THEMSELVES THE ACTUAL WORKS TO BE CARRIED OUT BEFORE
SUBMITTING THE TENDER.

TENDERERS MUST VISIT THE SITE, INSPECT AND SUBMIT A COMPETITIVE BID
FOR THE BUY BACK OF THE EXISTING FURNITURES IN THE RESPECTIVE
COLUMNS PROVIDED IN THE TENDER DOCUMENTS

Bills of Quantities and Schedule for the Interior furnishing works for
M/s. Bank of India, Kabisthalam Branch, Madurai, Tamilnadu.

S.No	Particulars	Qty.	Unit	Date	12.11.2024
				Rate (Rs.)	Amount (Rs.)
1	CONCEPT WALL PAINTING (Side Walls of cash) Providing & applying white plastic emulsion paint of Asian paints/ICI Dulux/ Berger and Sporty Yellow –X104 shade of royal luxury emulsion of Asian paints in minimum 2 coats including scrapping, opening of existing cracks, filling up of “V” cracks with epoxy expandable putty to required depths, making good weak plastered/ unplastered surfaces with cement plaster wherever required. Item to include plaster of Paris, primer, patti & making good existing surface to receive new paint including cleaning on completion of painting work etc.complete in all respects				
a	waiting area wall	240.00	Sft	25.00	6,000.00
2	FALSE CEILING (Gypsum Board) Providing and fixing in position false ceiling in Gypboard 12 mm thick for horizontals & verticals fixed over G.I frame work as specified by India Gypsum Co.ltd including trap doors for A.C unit in 18mm thick MR Grade plywood with stainless steel hinges & locks with moulding 1” x 1” for edges including finishing with 2 coats of putty and one coat primer and 2 coats of white plastic emulsion paint etc.complete in all respects. (Note: - Only the plan area will be measured for payment will be made for cutouts, grooves, mouldings etc.)				
a	Manager cabin	70.00	Sft	70.00	4,900.00
b	Banking hall	231.00	Sft	70.00	16,170.00
3	CORNICE WORKS Molding and fixing of POP Cornice molded with plaster of Paris and coconut fiber reinforcement finished duly as per the design given.				
		N.A	Rft	75.00	N.A
4	FALSE CEILING (Armstrong) Providing & fixing in position false ceiling in Armstrong 600 x 600mm x 15/16 mm Dune supreme RH 99 Prima tile with tegular edge frame work as specified by Armstrong co with suspends wherever required. Making necessary frame work for A.C ducting, and necessary cutouts for diffusers and light fittings, taping and finishing to proper line level, including making grooves and trap doors for A.C unit in 18 mm thick M.R grade plywood with Stainless steel hinges, locks with moulding				

S.No	Particulars	Qty.	Unit	Rate (Rs.)	Amount (Rs.)
	1"x1 " for edges including finishing with white plastic emulsion paint complete in all respects. (includes step ceiling)(Note: - Only plan area be measured for payment) No additional payment for cutouts, grooves, mouldings etc.				
a	Manager cabin	52.00	Sft	90.00	4,680.00
b	Banking hall	604.00	Sft	90.00	54,360.00
5	VERTICAL BLINDS				
	Supplying and fixing of vertical blinds made of 3" wide stripes (fabric made) fixed with use of plastic holders and aluminum section. The whole assembly is to be fixed with due aluminum brackets	100.00	Sft	60.00	6,000.00
6	FRONT OFFICE COUNTERS				
i	Providing and fixing in position Front office counter 2'6" wide with the following specifications comprising of the following complete in all respects:- Working top made with 25mm thick plywood finished with 1mm thick laminate. Outside edge of the working top shall be provided with 1 1/4" x 1" teak wood moulding finished with melamine polish. Inside edge will be provided with 1/2" x 1" T.W beading patti with melamine finish.				
ii	Vertical facia (Apron) made with 18mm thick plywood finished with 1mm thick laminate with 1mm thick groove at the joint of laminates of two different shades.				
iii.	Vertical drop (horizontal band) shall be provided on the facia below the working top made with 18mm thick plywood finished with 1mm thick laminate with provision for concealed light, 1mm thick groove shall be provided at the joint of two different shades of laminate.				
iv.	Glazed partition above working top to be provided with 12mm thick clear glass cut to the standard shape fixed to partition as per fixing details and to boxing with concealed S.S finished 'D' brackets. The exposed edges of the glass shall be finished in mirror polish.				
v.	3'-10" high boxing (10" x 10") made with 12mm thick plywood finished with 1mm thick laminate including providing and fixing 6mm thick square frosted glass at a height 3'-2" above finished floor level.				
vi	1'-9" high boxing (5" x 5") made with 12mm thick plywood finished with 1mm thick laminate.				

S.No	Particulars	Qty.	Unit	Rate (Rs.)	Amount (Rs.)
vii	Vertical supports made with 18mm thick plywood finished with white enamel paint.				
Viii	Telescopic CPU stand/ ready made keyboard tray shall be provided of approved model and make				
ix.	Footrest made with T.W member of size 4"x 1½" finished with french polish.				
x.	Drawer units as per drawing shall be provided with multipurpose godrej locks in each drawer. Facia of drawer unit shall be finished with 1mm thick laminate and all other sides shall be finished with white enamel paint. The drawers will be provided with handles (Stainless steel finish) and channels as per approval of the Project consultant/ Bank.				
xi	Boxing made with 12mm thick plywood finished with synthetic enamel paint shall be provided below the table top for electrical conduiting and at the bottom for the LAN cabling/Telephone wire conduiting. The item to include all necessary hardware and fittings in stainless steel finish, lipping to all edges and making provision only for electrical fitting behind the front. Vertical drop and also in the 10" x 10" boxing. Necessary beadings with melamine polish for fixing glass are to be provided.	21.00	Rft	3450.00	72,450.00
7	PANTRY COUNTER Fabrication and Fixing of running pantry counter of 19 mm plywood finished with 1mm tk laminate on the outer exposed sides and duco automotive paint on the inner sides so as to match the color of the interiors. The work has to be completed as per architect's direction.				
a.	Pantry Counter	14.00	Rft	990.00	13,860.00
b.	Dafthry Counter	3.00	Rft	1650.00	4,950.00
8	CASH COUNTER:- (including side credenza) Providing and fixing in position cash counter 2'-9" wide comprising of the following :				
i	Working top made with 25mm thick plywood finished with 1mm thick laminate. Outside edge of the working top shall be provided with 1¼" x 1" Teak wood moulding finished with melamine polish. Inside edge will be provided with ½" x 1" T.W beading patti with melamine polish.				

S.No	Particulars	Qty.	Unit	Rate (Rs.)	Amount (Rs.)
ii.	Vertical facia (Apron) made with 18mm thick plywood finished with 1mm thick laminate with 1mm thick groove at the joint of laminates of two different shades.				
iii.	Vertical drop (horizontal band) shall be provided on the facia below the working top made with 18mm thick plywood finished with 1mm thick laminate with provision for concealed light, 1mm thick groove shall be provided at the joint of two different shades in laminate.				
iv.	Glazed partition 1'-4" height above working top provided with 12mm thick toughened and frosted glass besides non-transparent film from inside fixed to partition as per fixing details and to boxing with concealed S.S finished 'D' brackets. The exposed edges of the glass shall be finished in mirror polish.				
v.	Transcription top shall be provided with 12mm thick toughened glass (partly glazed partly frosted) fixed horizontally with concealed stainless steel D bracket. Both exposed edges (inside and outside) glass shall be moulded and finished in mirror polish.				
vi.	Glazed partition having height 1'0" above the transaction top (in facia) shall be provided with 12mm thick glass (clear) with cut out of 8" x 4". The edges of cutout and the top edge of glass are to be mirror polished and to be fixed to partition as per fixing details and to boxing with concealed S.S finished 'D' brackets. The exposed edges shall be finished in mirror polish.				
vii.	7'-7" high (10" x 10") made with 18mm thick plywood with 1'-6" horizontal extension at the top including providing and fixing 6mm thick square frosted glass at a height of 5'-11" above finished floor level.				
viii	1'-9" high boxing (5" x 5") made with 12mm thick plywood finished with 1mm thick laminate.				
xi.	Telescopic CPU Stand / ready made keyboard tray shall be provided of approval model and make.				
x.	Footrest made with T.W member of size 4" x 1½" finished with French polish.				

S.No	Particulars	Qty.	Unit	Rate (Rs.)	Amount (Rs.)
xi.	Drawer units shall be provided and each drawer should have vertical partitions for keeping the currency notes and multipurpose Godrej locks. Facia of drawer unit shall be finished with 1mm thick laminate and all other sides shall be finished with white enamel paint. The drawers will be provided with handles (Stainless steel finish) and channels as per approval of the project consultant/ bank.				
xii.	Boxing made with 12mm thick plywood finished with synthetic enamel paint shall be provided below the table top for electrical conduiting and at the bottom for the LAN cabling/Telephone wire conduiting. The item to include all necessary hardware and fittings in stainless steel finish, lipping to all edges and making provision only for electrical fitting behind the vertical drop and also in the 10" x 10" boxing. Necessary beadings with matching melamine polish for fixing the glass are to be provided as directed.	5.50	Rft	3960.00	21,780.00
9	SOLID FULL HIGH WOODEN PARTITION Providing & fixing in position solid full height partition in frame work including door of size (3'0" x 7'0") in 2' x 2' grid (horizontally and vertically) comprising of 2" x 1½" T.W section 6mm thick plywood on both sides finished with 1 mm thick laminates of approved make and colour. Item to include 2" x 2" T.W member for doorframe. All exposed surfaces to be finished in melamine polish of matching laminate colour as directed including all necessary stainless steel finish fittings/hardware, door closers, Godrej locks and wood preservative paint etc. as per list approved by the project consultant/bank complete in all respects. (Note: In case of false ceiling, the vertical T.W members to be fixed with pucca ceiling but the area of partition payable will be below the false ceiling only).				
a.	Back office partition (near strong room wall)	110.00	Sft	310.00	34,100.00
10	PARTLY GLAZED PARTITION FOR CASH CABINS Providing and fixing in position 7'-7" high partly glazed partition for cash cabins in frame work at 2' x 2' grid (horizontally and vertically) comprising of 2" x 1½" TW section and/ or as per frame work with 6mm plywood on both sides finished with 1mm thick laminates of approved shade and colour. Item to include door of size 2'6" x 7'0" with etching and frosting as per design and 2" x 2" T.W. member for door sides and glass sides and T.W door frame to take 8mm thick glass with etching and frosting. The door will be provided with				

S.No	Particulars	Qty.	Unit	Rate (Rs.)	Amount (Rs.)
	T.W louvers finished in melamine polish of matching laminate colour. The doors are also to be provided with godrej night latch. Two wooden trays are to be provided Necessary cutouts are to provided in the glass and the edges of the glass cutouts are to be finished in mirror polish. All exposed T.W surfaces to be finished in melamine polish of matching laminate colour as directed including all necessary stainless steel finish fittings/ hardware, door closers, Godrej locks and wood preservative paint etc. as per list of approved material and as approved by the project consultant/ bank complete in all respects				
	a. Sides & front of cash counter (<i>incl of door</i>)	155.00	Sft	330.00	51,150.00
	b. Top of cash counter with Al grills (<i>incl, Dafthry area</i>)	58.50	Sft	210.00	12,285.00
11	PARTLY GLAZED FULL HEIGHT PARTITION Providing and fixing in position partly glazed full height partition work in frame work at 2' x 2' grid (horizontally and vertically) comprising of 2" x 1½" T.W section and/ or as per frame work with 6mm plywood on both sides finished with 1mm thick laminates of approved shade and colour. Item to include door of size 3'0" x 7'0" with etching and frosting as per design and 2" x 2" T.W. member for door sides and glass sides and T.W door frame to take 8mm thick glass with etching and frosting. All exposed T.W surfaces to be finished in melamine polish of matching laminate colour as directed including all necessary stainless steel finish fittings/ hardware, door closers, Godrej locks and wood preservative paint etc. as per list of approved material and as approved by the project consultant/ bank complete in all respects. (Note : In case of false ceiling, the vertical T.W members to be fixed with pucca ceiling but the area of partition payable will be below the false ceiling only)				
a	Manager cabin partition (9'6" ht)	225.50	Sft	320.00	72,160.00
b)	Fixed glass partition at entrance door area	72.00	Sft	310.00	22,320.00
12	PARTLY GLAZED LOW HEIGHT PARTITIONS Providing and fixing in position partly glazed low height partition (2½" thick) in frame work with T.W vertical members at 2'c/c and 3 horizontal members at equal distance comprising of 2" x 1½" T.W section with 6mm plywood on both sides finished with 1mm thick laminates of approved make and shade. Item to include 12mm thick glass (clear/frosted) to be fixed. The exposed edges of the glass to be finished in mirror polish. T.W runner should be melamine polished in matching colour of laminate etc., completed in all respects.				
	Side partition of Running Counter (4'6" ht)	74.50	Sft	320.00	23,840.00
	Wicket Gate(4'6"ht)	13.50	Sft	320.00	4,320.00

S.No	Particulars	Qty.	Unit	Rate (Rs.)	Amount (Rs.)
13	FULL HIGH GYPSUMBOARD PARTITION Fabrication and erection of glazed partition, with use of gypsteel section on both sides, for a thickness of 3", both sides of the section to be finished with gypsum board (star India, Gypsum India) duly filled in the joints and finished with paper for. all joints. All openings are to be strengthened on the edges with additional gypsteel all joints. All openings are to be strengthened on the edges with additional gypsteel section in order to fix glass (float glass). Inclusive of fixed glazing of size varying as per site condition with 8mm tk glass fixed as as per specification including painting. (up to a height of 10'6" from FFL).				
	a) Record(Store) room partition / Dining	346.50	Sft	140.00	48,510.00
	b) Safe room partition	92.50	Sft	140.00	12,950.00
14	MANAGER TABLE Providing and fixing in position Manager's table of size 6'-0" x 3'-0" including side storage (Credenza) by using 25mm thick plywood for top an 18mm thick plywood for all other horizontal and vertical members. Telescopic CPU Stand/ready made keyboard tray shall be provided of approved model and make. Footrest made with T.W member of size 4" x 1½" finished with French polish. Facia of side storage (Credenza) shall be finished with 1mm thick laminates and all other sides shall be finished with white enamel paint. The side storage (Credenza) shall be provided with handles (stainless steel finish) and channels as per approval of the project consultant /Bank. All exposed plywood surfaces to be finished with 1mm tk laminate of approved make & shade, and all exposed edges of table top & ply verticals to have 1" x ¼" T.W lipping. All exposed T.W sections to be melaminated and internal surfaces to have white enamel paint as directed. Item to include plywood boxing, all necessary hardware and fittings in stainless steel finish, lipping to all edges etc.complete in all respects.				
		1.00	No	20300.00	20,300.00
15	OFFICER TABLE (STAFF TABLE) Providing and fixing in position Officer's table of size 4'0" x 2'0" excluding side storage (Credenza) by using 25mm thick plywood for top and 18mm thick plywood for all other horizontal and vertical members. Telescopic CPU stand/ ready made keyboard tray shall be provided. Drawer units shall be provided with multipurpose Godrej locks in each drawer. Facia of drawer unit shall be finished with 1mm thick laminate and all other sides shall be int. The drawers will be provided with handles (Stainless steel finish) and channels as per approval of				

S.No	Particulars	Qty.	Unit	Rate (Rs.)	Amount (Rs.)
	the project consultant/ bank. All exposed plywood surfaces to be finished with 1mm tk laminate of approved make & shade, and all exposed edges of table top & ply verticals to have 1" x 1/4" T.W lipping. All exposed T.W sections to be melaminated and internal surfaces to have white enamel paint as directed. The item to include plywood boxing, all necessary hardware and fittings in stainless steel finish, lipping to all edges etc. complete in all respects. (with out side credenza)	4.00	Nos	12250.00	49,000.00
16	FULL HEIGHT STORAGE/ LOW HEIGHT STORAGE/ BACK STORAGE (Credenza) Providing and fixing in position full height storage/ low height storage/ Back storage (Credenza) respectively using plywood of required thickness finished with 1mm thick laminates and all other sides shall be finished with white enamel paint. The storage units shall be provided with handles (Stainless steel finish) as per approval of the project consultant/bank. All exposed plywood surfaces to be finished with 1mm tk laminate of approved make & shade 1" x 1/4" T.W lipping. All exposed T.W sections to be melaminated in matching colour laminate and internal surfaces to have white enamel paint. Item to include all necessary hardware and fittings in stainless steel finish, Godrej multi purpose locks including magnetic ball catcher etc., complete in all respects.				
a	Full high storage - (7'0" ht) (Record room)	193.00	Sft	540.00	104,220.00
b	Half high storage – (3'0" ht) (BM cabin & behind JPR)	60.00	Sft	570.00	34,200.00
c	Side credenza – (2'6" ht) - 8nos	60.00	Sft	570.00	34,200.00
17	LOFT STORAGE (above lintel ht) Supply fabrication and erection of loft storage for additional storages out of ms pipes of size 4" x 2" x 2mm thk and top covered with 19mm thick chequered plate to form base for loft storage. The entire grid assembly of pipes to be supported by puncturing the existing walls to provide for suitable bearing within the existing brick walls for the main frames. The punctured openings to be properly sealed off with baby jelly concrete and cement plaster and finished with paint as per architect direction. The ms sections to be painted with touch up putty, 2 coats of zinc chromate and finished with 2 coats of enamel paint as per architect direction. (safe room, infront of strong room & dining and back office area)				
a	Open Storage (store area below lintel for 7'0" ht)	N.A	Sft	N.A	N.A
b	Loft above Open Storage from lintel upto 2'6" ht)	N.A	Sft	N.A	N.A

S.No	Particulars	Qty.	Unit	Rate (Rs.)	Amount (Rs.)
18	FULL HEIGHT SOLID DOOR Full ht.solid 33mmthk flush door of size as specified fully finished with 1mm laminate with approved shade, provide door with door closer ,edge lipping lock and SS handle all complete incl 4" x 3" wooden door frame.				
a	<i>Pantry. Saferoom, Stationery & wash room (3'0" x 7'0") x 4 Nos</i>	84.00	Sft	400.00	33,600.00
19	FULL HEIGHT GLAZED DOOR Full ht.solid 35mmthk flush door of size as specified fully finished with 12mm thick glass with 1mm laminate with approved shade, provide door with door closer, edge lipping lock and SS handle all complete including 4" x 3" wooden door frame. (Parly as sliding as per direction)				
a	<i>Back Office,Tufthry & Mgr cabin (3'0" x 7'0") x 4Nos</i>	84.00	Sft	590.00	49,560.00
20	WALL / COLUMN PANELLING –10'6" HEIGHT Paneling of with 12mm tk termite treated Waterproof plywood and finished with 4mm tk OST duly polished / 1mm tk laminate to match the interior décor, as per architect direction. (Free standing coloumns in banking hall only)				
a.	Manager cabin side walls	185.00	Sft	265.00	49,025.00
21	ENTRANCE DOOR Providing and fixing Entrance door (Glazed) in Silver andosied aluminium door section (Jindal make) in top and bottom, glazed with 12mm thick toughened glass of approved make with etching and frosting. Item to include floor springs, lock, all necessary hardware of stainless steel finish as approved by the project consultant/ Bank complete in all respects. Size – 6'0" x 7'0" x 1 No				
		48.00	Sft	590.00	28,320.00
22	EXTERNAL FIXED GLAZING Providing and fixing external fixed glazing comprising of 12mm Modifloat,Saint Gobain Asahi or equivalent make clear glass with top, bottom and vertical frame comprising of black powder coated aluminium members. Section made of 4" x 1½" bottom, side vertical and top 2½" x 1½" series of Jindal section (14 gauge) having 20 micron colored anodizing, having 12mm Modi Plain glass, best imported quality rubber gasket, all other accessories etc., complete in all respect as per directed and specified by Architects. Side of entrance door (8'0"ht)				
		N.A	Sft	N.A	N.A

S.No	Particulars	Qty.	Unit	Rate (Rs.)	Amount (Rs.)
23	FAÇADE OF ENTRANCE DOOR Providing and fixing in position Aluminium composite panel boxing with PVDF coating & LDPE core laminated Eurobond/ Altobond/ Alukbond exterior grade 4mm thick with composite of (0.5mm - 3mm – 0.5mm) including fabrication for the same with aluminium sections, required hardware, silicon sealant (Dow corning 789) masking tape, necessary scaffolding etc.complete in all respects.	38.50	Sft	310.00	11,935.00
24	SUGGESTION BOX Fabricating and fixing of suggestion box made of 18mm and 12mm plywood with drawers and lock arrangement at the bottom and a slit at the top. 12 mm glass ledge with beveled edges to half round shape suitably supported on plywood as per design. The box is to be finished with automotive paint so as to match the colour of the interiors	1.00	No	3850.00	3,850.00
25	WRITING LEDGE Fabricating and fixing of writing ledge and brochure holder size 5'0" x 1'6" made of 12mm glass supported with 18 mm marine plywood stand finished with duco automotive paint so as to match the color of the interiors. Glass edges beveled to half round shape suitably supported on plywood as per design. 4 mm tk plain glass without tints fixed in grooves for brochure holder as per design. The work has to be completed as per architect's direction. <i>(with a small suggestion box below)</i>	1.00	No	3240.00	3,240.00
26	PLANTER BOX Planter Box of size 1'9 x 1'9" height 15" made of 12 mm tk termite treated water proof plywood and finished with 4mm tk OST duly polished and finished as per architect direction. Planter pot containing artificial plants to be provided as per the architect's direction. Basic value of the artificial plant to be around Rs. 1800/- per piece	2.00	Nos	2150.00	4,300.00
27	NOTICE BOARD Fabrication and fixing of Notice board made of wooden frame filled with soft board covered with fur. The colour of the fur is to be selected by the Architect. The outer frame of the notice board is to be finished with automotive paint so as to match the colour of the existing wall. Size (6' x 4') along with Pin-up board. (Outer to have a teak wood frame duly polished)	24.00	Sft	250.00	6,000.00

S.No	Particulars	Qty.	Unit	Rate (Rs.)	Amount (Rs.)
28	PIN-UP BOARD PIN UP BOARD to be made out of 8mm thk. Soft board covered with textured felt of Blue colour as approved by he Architect. (Outer to have a teak wood frame duly polished as per directions)	24.00	Sft	N.A.	N.A.
29	MIRROR PANELING MIRROR PANELING in toilets & strong room made out of 6mm thk mirror of Modi/ Ashahi/ Saint Gobain with 8mm thk marine ply base with necessary moulding etc., as approve by the Architect. (3'0" x 2'0")	1.00	No	3600.00	3,600.00
30	ACCESSORIES (Star House Logo) Glass etched name plate with logo Supplying and fixing of Glass etched logo plate of size 2'6"x 2'0" 1 no	1.00	Sft	3900.00	3,900.00
31	NAME PLATES NAME PLATES at toilets, pantry, electrical room, store room as approved by the Architect	5.00	No's	450.00	2,250.00
32	BOXING FOR ROLLING SHUTTER Box with open able shutter & ceiling in 19mm tk ply for rolling shutter servicing with support in wooden frame, etc& complete with paint finish on all the sides	54.00	Sft	190.00	10,260.00
33	PAINTING - Front Office Walls Providing & applying white plastic emulsion paint of Asian paints/ICI Dulux/ Berger and Glacier White Code – 40028 shade of royal luxury emulsion of Asian paints in minimum 2 coats including scrapping, opening of existing cracks, filling up of “V” cracks with epoxy expandable putty to required depths, making good weak plastered/ unplastered surfaces with cement plaster wherever required. Item to include plaster of Paris, primer, patti & making good existing surface to receive new paint including cleaning on completion of painting work etc.complete in all respects.	573.00	Sft	23.00	13,179.00
34	PAINTING - Back Office Walls Painting two coats of primer & two coats of distemper of Nerolac/Asian. Allscapes Distemper or equivalent, in all areas of soffit including scaffolding, cleaning & supply of all materials complete. The work has to be completed as per Architect direction. This includes removing existing distemper by scrapping and scrubbing. (Old Records ,Stationary,Locker room, UPS room, Dining & Toilets)	1869.00	Sft	20.00	37,380.00

S.No	Particulars	Qty.	Unit	Rate (Rs.)	Amount (Rs.)
35	CEILING PAINTING - Back Office & Banking Hall Painting ceiling area with putty finish with two coats of primer & two coats of Glacier White (Code – 40028) colour emulsion paint of Nerolac Allscapes Emulsion or equivalent, in all areas of soffit including scaffolding, cleaning & supply of all materials complete. The work has to be completed as per Architect direction. This includes removing of existing distemper by scrapping & Scrubbing. (Store, Dining, UPS , Locker room & Toilets)	937.00	Sft	25.00	23,425.00
36	MISCELLENIOUS & UNFORSEEN WORKS	L.S.		L.S.	4,500.00
	TOTAL				1,017,029.00
	SAY				1,017,000.00
	<u>(In Words: Rupees Ten Lakhs and Seventeen Thousand Only)</u>				

**Bills of Quantities and Schedule for the Electrical Works at
M/s.Bank of India, Kabisthalam Branch, Madurai, Tamil Nadu.**

11.11.2024

S.No	Description	Qty	Unit	Rate (Rs.)	Amount (Rs.)
I	<u>Service Connection :</u>				
a)	Supply & Erection of EB Service connection with 4 Runs 7 / 16 PVC insulated copper wire with 2 Runs 7 / 20 G.I. Support wire including suitable reels, M.S. Service pipe, etc. with all accessories. (App. 22 mtrs.)	1	Set	Nil	Scope of landlord
b)	Supply & Erection of Areal Fuse Board with 3 Nos. 100 A Fuse Carriers	1	Set	Nil	Scope of landlord
c)	Supply & Erection of EB Metering Panel with 125 A Main switch with adaptor boxes, 3 Nos. 100 A Fuse carrier, Neutral Link, provision for Electronic EB Meter, interconnections with all materials, Earth Plate & Earthing with No.8 SWG Copper including 2 Nos. Earth Station as per I.S. Specification.	1	No	Nil	Scope of landlord
d)	Supply & Erection of 63 A TPN S / F (L&T / Seimens) suitable M.S. Boxes made out of 16 SWG CR Sheet Powder coat paint of approved colour for A/C incoming	2	Nos	Nil	Nil

II Main Distribution:

- a) Design, Fabrication, Supply & Erection of cubicle floor mounting type fully compartmentalised LT switch board, dust tight and vermin proof, fabricated out of 16 SWG CR sheet chemically treated powder coat paint of approved colour. The switch board should have suitably rated TPN Al. Busbar with specified current and fault level insulated with heat shrinkable colour coded PVC sleeve and using DMC / SMC busbar supports.

Incoming:

125 A TPN F/S with HRC Fuses - 1 No
(L & T / Seimens Make)

S.No	Description	Qty	Unit	Rate (Rs.)	Amount (Rs.)
	<u>Outgoing:</u>				
	63 A TPN F/S with HRC Fuses - 5 Nos. (L & T / Seimens Make)				
	<u>Metering on EB Incoming:</u>				
	0 to 600 A Voltmeter with SS - 1 No				
	RYB Indication Lamp with control fuse - 1 set				
	0 to 50 A Ammeter with SS - 1 No.	1	No	45,000.00	45,000.00
III	<u>Point Wiring :</u>				
1)	Supply & Erection of 3 phase MCB Distribution Board suitable for 8 ways per phase outgoing MCB's with 3 Nos. 3 phase 40 A Phase changer Selector Swtiches and 3 Nos. Piano switch with Indication Lamp supplied with phase Busbars, Earth Busbar and Internal wiring - 1 No. (for Lighting) 63A 4P MCB Isolater - 1 No.(as incoming) 10A SP MCB - 18 Nos. 15A SP MCB - 6 Nos.(as outgoing)	1	No	14,900.00	14,900.00
2)	Supply & Providing of Point wiring for light, fan, 6A switched socket, exhaust fans, etc., with 3 run PVC insulated FRLS Copper conductor(2R 1.5 sq.mm for phase/neutral & 1 R 1.5 sq.mm for earth) in 20 / 25mm, 2mm thick PVC conduit or caping & casing, with all accessories, to be concealed or exposed in wall / concrete, with chase cutting & filling, <u>including</u> supply & fixing of 6A 230V modular type switch/switched socket housed in manufactures Zinc passivated metal box with front plate to be concealed in the wall. (Maximum 8 mts of phase wire per point)				
a)	1 point controlled by one 6A switch	45	Nos	390.00	17,550.00
b)	1 point controlled by two 6A switch	3	Nos	445.00	1,335.00
c)	2 points controlled by one 6A switch	3	No	510.00	1,530.00
d)	3 points controlled by one 6A switch	1	Nos	550.00	550.00
e)	4 points controlled by one 6A switch	3	Nos	600.00	1,800.00
f)	5 points controlled by one 6A switch	1	No	650.00	650.00
g)	6 points controlled by one 6A switch	1	No	700.00	700.00
h)	6A plug point controlled by one switch fan	8	Nos	510.00	4,080.00

S.No	Description	Qty	Unit	Rate (Rs.)	Amount (Rs.)
3)	Supply & Providing of circuit mains with 2 Runs 2.5 sq.mm for phase / neutral & 1Run 1.5 sq.mm PVC insulated FRLS copper conductor for earthing in 19 / 25 mm dia 2mm thick PVC conduit or caping & casing, with all accessories, to be concealed or exposed in wall / concrete, with chase cutting & filling	345	mtrs	81.00	27,945.00
IV <u>Power Wiring :</u>					
1)	Supply & Erection of 3 phase MCB Distribution Board suitable for 8 ways per phase outgoing MCB's with 3 Nos. 3 phase 40 A Phase changer Selector Swtiches and 3 Nos. Piano switch with Indication Lamp supplied with phase Busbars, Earth Busbar and Internal wiring - 1 No. (for Power) 63A 4P MCB Isolater - 1 No.(as incoming) 10A SP MCB - 15 Nos. and 25A SP MCB - 9 Nos.(as outgoing)	1	No	11,450.00	11,450.00
2)	Point wiring for 16A switched socket with 2R 4 sq.mm & 1 R 2.5 sq.mm (for Earth) PVC insulated FRLS copper conductor in 19/25mm dia 2mm thick PVC conduit for caping & casing with all accessories to be concealed or exposed in wall / concrete including cost of chase cutting and filling.	315	mtrs	120.00	37,800.00
3)	Supply & Fixing of 6A / 16A 5 Pin 230 V modular type switched socket with indicator housed in manufacturers Zinc passivated metal box with front plate to be concealed in the wall, including cost of chase cutting & filling				
a)	6 A 2-in-1 socket with 6A switch	7	Nos	585.00	4,095.00
b)	16 A 2-in-1 socket with 16A switch	7	Nos	630.00	4,410.00
	for A/C points , Heaters additional charges etc. <u>Alternatively (for A/C Points):</u> 20 Amps 230V metal clad plug & socket DB (with 25 A SP MCB control) housed in manufacturers (Company make) metal box			Not	Applicable

S.No	Description	Qty	Unit	Rate (Rs.)	Amount (Rs.)
V	<u>UPS Wiring :</u>				
1)	Supply & Erection of MCB Distribution Board 230V (Company Make) suitable for 12 ways MCB's as outgoing with Acrylic Door and IP 42 protection - 1 No 40A SP&N MCB - 1 No as incoming 10A SP MCB - 10 Nos as outgoing	1	No	5,400.00	5,400.00
2)	Supply & Providing of UPS point wiring for 6A / 16A switched socket with 2R 2.5 sq.mm & 1R 1.5 sq.mm (for earth) PVC insulated FRLS copper conductor in 19/25mm dia 2mm thick PVC conduit or casing & casing with all accessories to be concealed or exposed in wall / concrete including cost of chase cutting & filling.	280	mtrs	82.00	22,960.00
3)	Supply & Fixing of 230 V , 6 Amps 5 pin 2 in 1 socket - 3 Nos. 16 Amps 5 pin 2 in 1 socket - 1 No. controlled by 1 No. 16Amps modular type switch with indicator housed in manufacturers Zinc passivated metal box with front plate to be concealed in the wall including cost of chase cutting & filling for computer terminals.	13	Nos	1,260.00	16,380.00
a)	Supply & Erection of 63A TPN MCB in suitable M.S. Boxes made out of 16 SWG CR Sheet chemically treated & Powder coat paint of approved colour for UPS incoming.	1	No	3,250.00	3,250.00
b)	Supply & Erection of 40A Phase selector changeover switch in suitable M.S.Boxes made out of 16 SWG CR sheet chemically treated & Powder coat paint of approved colour for UPS as incoming.	1	No	2,100.00	2,100.00
c)	Supply & Providing of Circuit Mains with 2 Runs 6 sq.mm & 1 Run 2.5 sq.mm PVC insulated FRLS Copper conductor for phase/ neutral & earthing in 19/25mm dia 2mm thick PVC conduit or casing, with all accessories, to be concealed or exposed in wall / concrete, including chase cutting & filling.(from phase selector switch to UPS and				

S.No	Description	Qty	Unit	Rate (Rs.)	Amount (Rs.)
	UPS to UPS DB.)	24	mtrs	145.00	3,480.00
d)	- do - for generator	20	mts	145.00	2,900.00
VI	<u>Telephone & Data System :</u>				
1)	Supply & Laying of 2mm thick 25mm dia PVC conduit including the cost of terminal boxes/junction boxes, conduit accessories as required and GI fish wire, complete for both data and telephone system.	275	mtrs	36.00	9,900.00
2)	Supply & Installation of 0.5mm dia PVC insulated 2 pair copper telephone cable drawn in the above conduit including terminations at both ends.	275	mtrs	25.00	6,875.00
3)	Supply & Installation of 0.5mm dia PVC insulated 10 pairs copper telephone cable drawn in the above conduit including termination at both ends.	215	mtrs	55.00	11,825.00
VII	<u>Cabling :</u>				
1)	Supply & Installation of 1.1 KV Grade Armoured PVC insulated EG cable with Cu. Conductor as per I.S. 1554 (part-I)1976				
a)	4C 16 sq.mm Cu. Cable (EB main to SSB - 22 mtrs)	28	mtrs	540.00	15,120.00
b)	4C 6 sq.mm Cu. Cable (SSB to Power MCB DB - 20 mtrs SSB to UPS - 20 mtrs SSB to AC Plant - 15 mtrs)	48	mtrs	315.00	15,120.00
c)	10c 1.5 sqmm Cu cable (<i>4nos AC units @ Banking hall</i>) (for A.C control wiring)	95	mtrs	390.00	37,050.00
2)	Supply & Providing end termination for the following sizes of UG cable including Gland earthing				
a)	4C 16 sq.mm Cu. Cable	7	Nos	540.00	3,780.00
b)	4C 6 sq.mm Cu. Cable	14	Nos	370.00	5,180.00
c)	10 C 1.5 sq.mm Cu. Cable	4	Nos	270.00	1,080.00

S.No	Description	Qty	Unit	Rate (Rs.)	Amount (Rs.)
VIII <u>Earthing :</u>					
1)	Supply & Installation of following sizes of copper wire and termination of same at both ends with crimping type copper sockets. All installation materials like clamps, bolt and nuts are to be supplied by contractor.				
a)	No.10 SWG Copper for body & UPS earthing	120	mtrs	78.00	9,360.00
b)	No.8 SWG Copper for Gen Neutral and body earthing	80	mtrs	90.00	7,200.00
2)	Supply, Fabrication & Erection of 40mm dia B' class 2.5m long G.I. Earth station with alternate layers of slat & charcoal as per dedicated earthing I.S. Specifications for Gen Earthing -1 Exst EB earthing - 2 Computer UPS - 1	3	Nos	6,300.00	18,900.00
IX <u>Fixtures & Fittings :</u>					
	Supply, delivery at site, receiving, storing, handling carriage at site, assembling, erection including the down rods as required at site, connecting, testing and commissioning of the following Ceiling / wall mounted light fixtures including the lamps. (All fixtures to be of Wipro/Philips/Havells make only and lamps of GE / Osram make only).				
a)	1 x 33 w LED square downlight Recess Mounted (Philips RC 375 B 30S) (2' x 2' fitting) (Incl Frame)	26	No	3,045.00	79,170.00
b)	1 x 22 w Philips Square Ultraslim (Al body) 9"x 9"	8	Nos	1,360.00	10,880.00
c)	1 x 18 w LED Ultraslim Square light (Al body)	2	Nos	1,070.00	2,140.00
d)	1 x 50 w Halogen spot light (Al body)	4	Nos	850	3,400.00
e)	1 x 7 w LED Square Spot light COB+ (Al body)	N.A.	Nos	N.A.	N.A.
f)	CG Wall Mount Fan (Crompton / Usha)	8	Nos	2,360.00	18,880.00
g)	48" CG Highspeed Ceiling Fan (Crompton / Usha / H	2	No	2,210.00	4,420.00
h)	1 x 21 w LED Tube fitting Smart Bright 4feet (Al body	10	No	510.00	5,100.00
i)	Exhaust fan (9" exhaust almonored) <i>Including provision for Opening & plastering wherever required) (Toilet & UPS Battery Room)</i>	4	Nos	1,860.00	7,440.00

S.No	Description	Qty	Unit	Rate (Rs.)	Amount (Rs.)
X	Generator :				
a)	Supply & Erection of 100 A 4P Changeover Switch with suitable Adaptor Box.	1	No	5,400.00	5,400.00
XI	Capacitor (Only provision for wiring):				
a)	Supply, Erection, Testing & Commissioning of 10 KVAR Heavy Duty capacitors with necessary Adaptor Boxes & Wiring to be connected to EB Mains. / provision for wiring only.	1	No	2,700.00	2,700.00
XII	<u>General :</u>				
a)	Rectifying, Testing, Erection and Commissioning of existing light points with fittings	5	Nos	525.00	2,625.00
	Total				513,810.00
	Say				514,000.00
	<u>(Rupees: Five Lakhs and Fourteen Thousand Only)</u>				

Bill of Quantities and Schedule for the Data cabling works
at M/s.Bank of India, Kabisthalam Branch, Madurai, Tamil Nadu.

				Date	11.11.2024
S.No	Description	Qty	Unit	Rate (Rs.)	Amount (Rs.)
I	<u>Data Cabling Works</u>				
a)	Supplying & Fixing of HCL CAT 6 10/100/1000 Mbps UTP Cable including the cost of laying the cable etc.complete	560	Mts	45.00	25,200.00
b)	Supplying & Fixing of HCL CAT 6 Single information Outlet including the cost of Punching & Fixing etc.complete	14	Nos	460.00	6,440.00
c)	Supplying & Fixing of HCL 24 Port 10/100 Mbps Fast Ethernet Switch	1	Nos	4,800.00	4,800.00
d)	Supplying & Fixing of HCL CAT 6 24 Port Patch Panel including punching & Fixing etc.complete	1	Nos	3,600.00	3,600.00
e)	Supplying & Fixing of HCL CAT 6 3 Feet Patch cord	14	Nos	220.00	3,080.00
f)	Supplying & Fixing of HCL Cat 6 7 Feet Patch cord (PC to IO)	14	Nos	250.00	3,500.00
g)	Supplying & Fixing of HCL 19" 9U Rack with power manager & Cable Manager with fasteners including the cost of rack fixing etc.complete	1	Nos	4,650.00	4,650.00
	Total Amount				51,270.00
	SAY				51,000.00
	<u>(Rupees Fifty One Thousand Only)</u>				

Bills of Quantities and Schedule for the Air conditioning Works at
M/s.Bank of India, Kabisthalam Branch, Madurai, Tamil Nadu.

**PROPOSAL FOR NEW GENERATION PACKAGED AC's / DUCTED SPLIT AC's
FITTED WITH POWER SAVER SCROLL COMPRESSORS.**

Date 11.11.2024

ANNEXURE – 1

BASIS OF DESIGN

Area to be air conditioned	770.00 Sq.ft
Outside Design conditions	100 F DB and 83 F WB
Inside Design conditions	75 F + 2% DB and RH not exceeding 50%.
Lighting Load	1 watts per Sqft.
Equipment Load	12 Computers + 3 Printers
Occupancy Factor	30 persons
Fresh Air	One Air changes per Hour
Power Supply	415 V, 50 Hz, 3 PH. To be shaded by using sun control
Exposed Glass	films or by thick curtains.
Exposed Roof	To be insulated by 50 mm thick TFquality thermocole or equivalent material. (In case of exposed roof.)

Note:

Contractors must inspect the site prior to submission of rates, and quote rates accessing site condition inclusive of additional stands, practical length of copper and drain pipes etc complete.

ANNEXURE – 2
SCOPE OF WORK :

S.No.	Description	Unit	Qty	Rate	Amount
I	MANAGER CABIN				
I	1.0 TR High Wall split air conditioner Inclusive of 3 kva stabilizers, cordless Remote of Voltas/Blue star/Hitachi orEquivalent make, with sufficient copper Piping and drain pipe including transport, Erection and commissioning at site etc Complete. (with 3 star rating)	No	1	33,500.00	33,500.00
II	BANKING PREMISES				
I	1.5 TR High Wall split air conditioner Inclusive of 4 kva stabilizers, cordless Remote of Voltas/Blue star/Hitachi or Equivalent make, with sufficient copper Piping and drain pipe including transport, Erection and commissioning at site etc Complete. (with 3 star rating)	No	1	39,000.00	39,000.00
II	2.0 TR High Wall split air conditioner Inclusive of 4 kva stabilizers, cordless Remote of Voltas/Blue star/Hitachi or Equivalent make, with sufficient copper Piping and drain pipe including transport, Erection and commissioning at site etc Complete. (with 3 star rating)	Nos	2	48,500.00	97,000.00
TOTAL AMOUNT				Rs	169,500.00
SAY				Rs:	170,000.00
<i>(Rupees: One Lakh and Seventy Thousand Only).</i>					

**Net Total Abstract Estimate for Air-Conditioning Works for
Banking Hall & Manager cabin At Bank of India,
Kabisthalam Branch, Madurai,Tamilnadu.**

Notes: All items are excluding of GST and other applicable taxes, unless specified

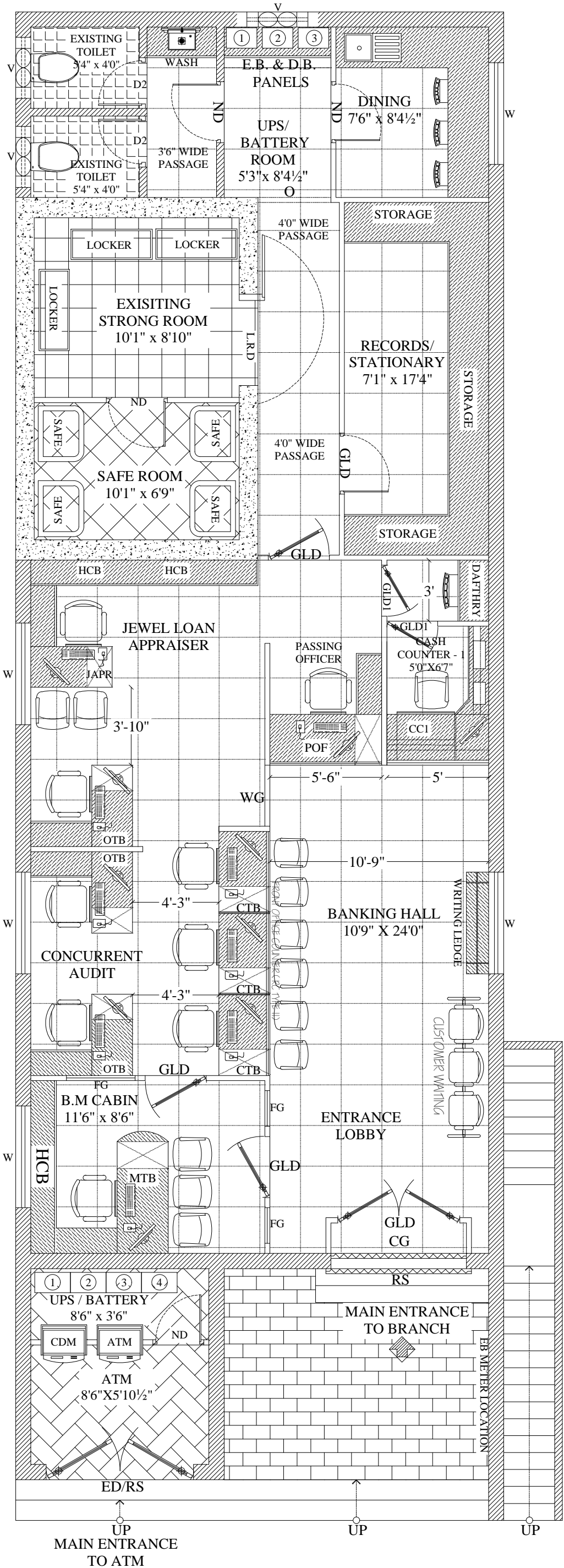

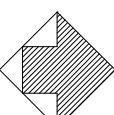
<p>PROPOSED INTERIOR LAYOUT PLAN FOR M/s.BANK OF INDIA, AT KABISTHALAM BRANCH, THANJAVUR, TAMIL NADU.</p>		<p>NOTES:</p> <div><p>NORTH</p></div>		<p>TITLE: SCHEMATIC DRAWING - INTERIOR LAYOUT PLAN GROUND FLOOR PLAN-OPTION- I</p>		<p>ARCHITECT: <u>S.VIJAY ANAND B.Arch, Mem COA, AIIA.</u></p>
<p>AREA DETAILS :</p>		<p>SCALE:</p>	<p>ALL MEASUREMENTS ARE IN FEET & INCHES THE DRAWING STRICTLY TO BE READ AND NOT MEASURED</p>			
<p>DRAWN BY: YASMIN</p>		<p>CHECKED BY: ANAND</p>				
<p>DATE: 23.10.2024</p>		<p>PLATE NO:BO/KABISTHALAM/SD/GF/INT/01</p>				
<p>AVANT GARDE</p> <div><p>DESIGN CONSULTANTS</p><p>ARCHITECTURE & INTERIORS</p><p>#1281, TRICHY ROAD</p><p>COIMBATORE - 641 018</p><p>Ph: 2301 246, Fax: 2301 191</p></div>						

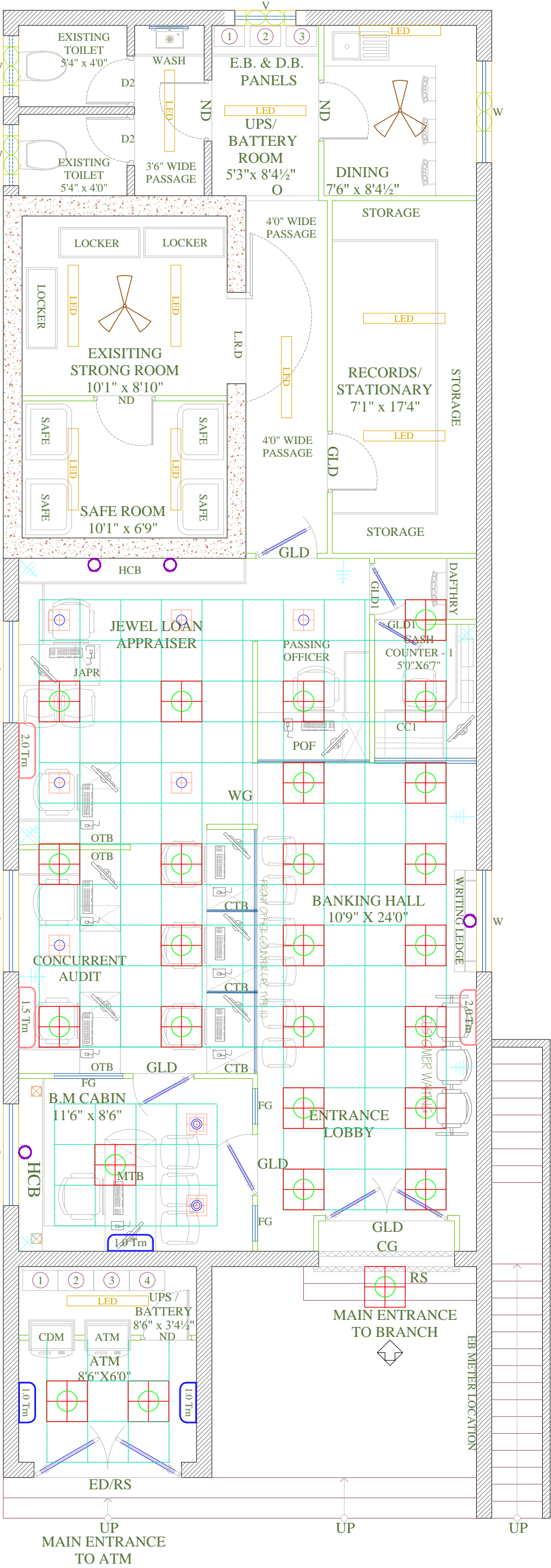

LEGEND

<div> <div></div> <div>1 x 33 w LED (2' x2')</div> <div>Square downlight</div> <div>26 Nos.</div> </div>	<div> <div></div> <div>1 x 22 w LED Ultralim</div> <div>Square down light</div> <div>8 Nos.</div> </div>	<div> <div></div> <div>1 x 18 w LED Ultralim</div> <div>Square down light</div> <div>2 Nos.</div> </div>	<div> <div></div> <div>LED</div> <div>Ordinary Pating fitting (wipro)</div> <div>10 Nos.</div> </div>	<div> <div></div> <div>Ceiling Fan</div> <div>02 Nos</div> </div>	<div> <div></div> <div>Exhaust Fan</div> <div>04 Nos.</div> </div>	<div> <div></div> <div>Wall Fan</div> <div>8 Nos.</div> </div>	<div> <div></div> <div>1x 5/7 w LED Spot lights</div> <div>04 Nos</div> </div>	<div> <div></div> <div>1.0 Trm</div> <div>1.0 Trm AC unit</div> <div>03 Nos</div> </div>	<div> <div></div> <div>1.5 Trm</div> <div>1.5 Trm AC unit</div> <div>01 No</div> </div>	<div> <div></div> <div>2.0 Trm</div> <div>2.0 Trm AC unit</div> <div>02 Nos</div> </div>	<div> <div></div> <div>2.5 Trm</div> <div>2.5 Trm AC unit</div> <div>Nil</div> </div>
--	--	--	---	---	--	--	--	--	---	--	---

NOTES:

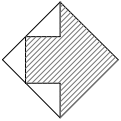

NORTH

TITLE:

ELECTRICAL DRAWING - INTERIOR LAYOUT PLAN
GROUND FLOOR PLAN-OPTION- I

SCALE:

ALL MEASUREMENTS ARE IN FEET
& INCHES
THE DRAWING STRICTLY TO BE READ
AND NOT MEASURED

ARCHITECT:

S.VIJAY ANAND B.Arch, Mem COA, AIIA.

AREA DETAILS :

DRAWN BY:

YASMIN

CHECKED BY:

ANAND

DATE: 09.11.2024

PLATE NO:BOI/KABISTHALAM/ED/GF/INT/01

AVANT GARDE

DESIGN CONSULTANTS

ARCHITECTURE & INTERIORS

#1281, TRICHY ROAD
COIMBATORE - 641 018

Ph: 98422 30124.

PROPOSED INTERIOR LAYOUT
PLAN FOR M/s.BANK OF INDIA,
AT KABISTHALAM BRANCH,
THANJAVUR, TAMIL NADU.